

## ● Disassembly

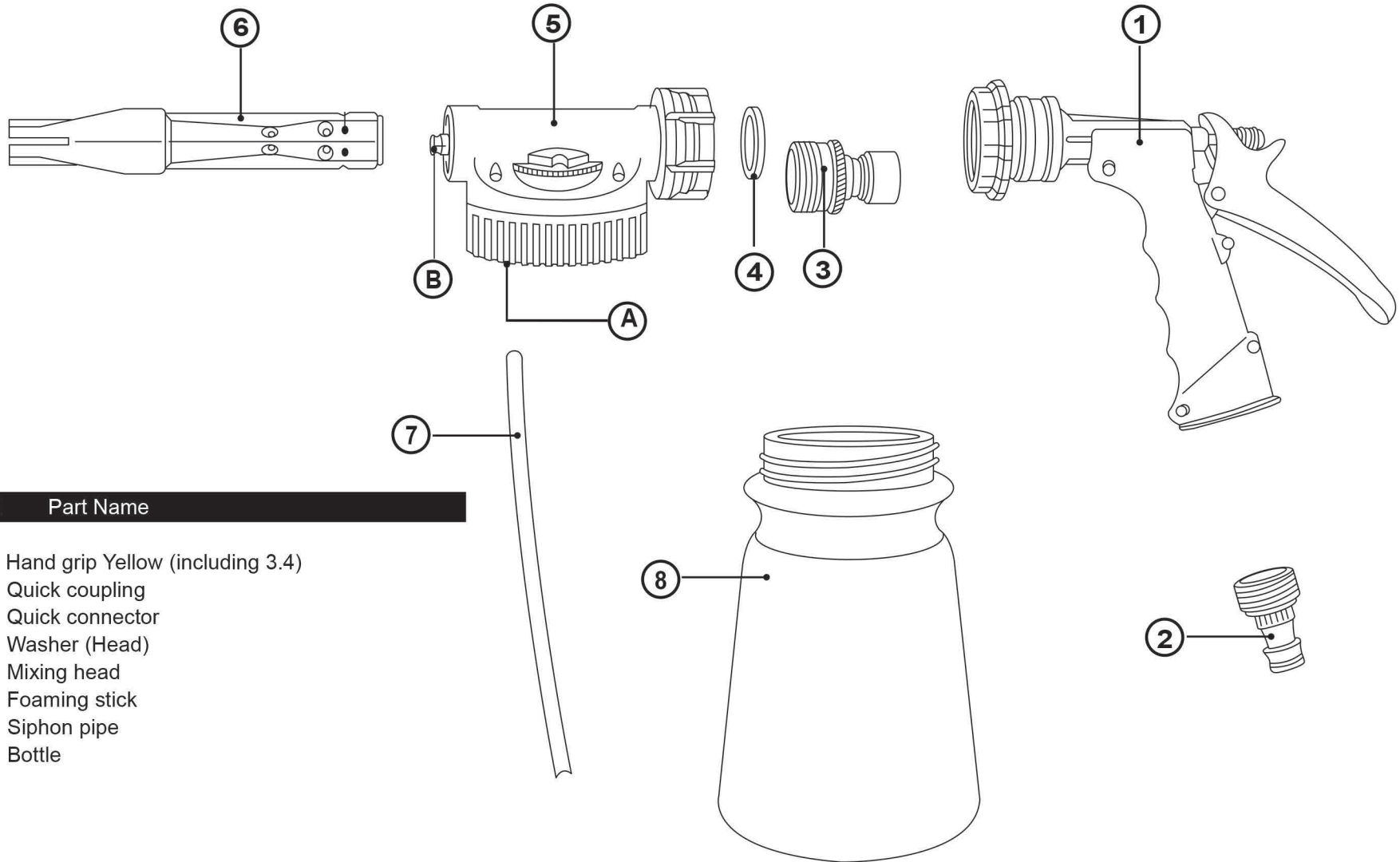

### SN Part Name

- 1 Hand grip Yellow (including 3.4)
- 2 Quick coupling
- 3 Quick connector
- 4 Washer (Head)
- 5 Mixing head
- 6 Foaming stick
- 7 Siphon pipe
- 8 Bottle

### Process of washing vehicle:

1. First spray the vehicle with the water gun.  
Spray foam on the vehicle.
2. Connect the foamed gun head with the water gun.
3. Wipe the vehicle with sponge (optional).
4. Disconnect the foamed gun head and wash the vehicle with water gun.
5. Wipe the vehicle with clean rag to dry.

### The assembly drawing of Foam King:

- a. Foam gun pipe b. Foam gun body c. Washing liquid container
  - d. water gun
1. Connect the water gun with the foam gun body.
  2. Connect the foam gun body with gun pipe.
  3. Wash vehicle with connected foam gun.
  4. Connect the water gun jointer with the Hose Kit.
  5. Connect the Hose Kit with Tap water faucet to use.

- Water pressure: 2.5 bars to 6 bars.
- Use the Tuning Dial to adjust the dilution ratio.

Position of Tuning dial	0	1	2	3	4	5
Standard ratio	10	20	30	40	100	300